

ATTENTION: Assemble all parts on a solid surface (not carpet) or damage will occur!

VERY IMPORTANT!

Assemble all parts on a smooth, hard surface such as wood or concrete.

DO NOT assemble on soft surfaces such as carpet or damage will occur.



Indentation

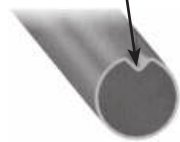

The ends of the steel tubes are intentionally indented to ease assembly.

Firmly tap tubes all the way into each socket. If this is not done, the product will not stay together.

SHOE RACK PARTS LIST

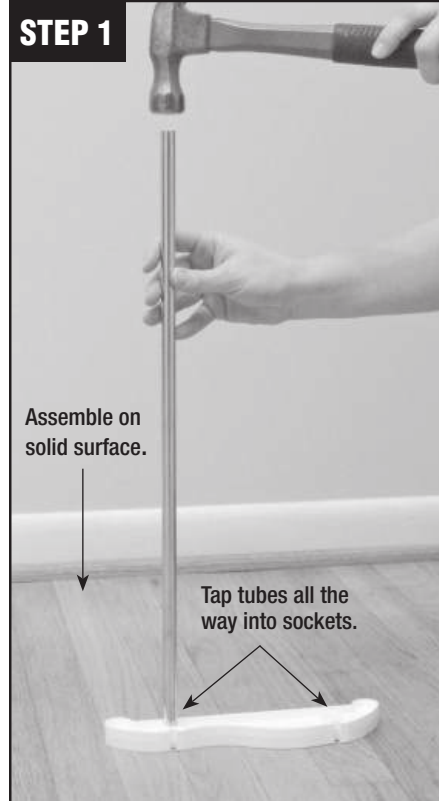
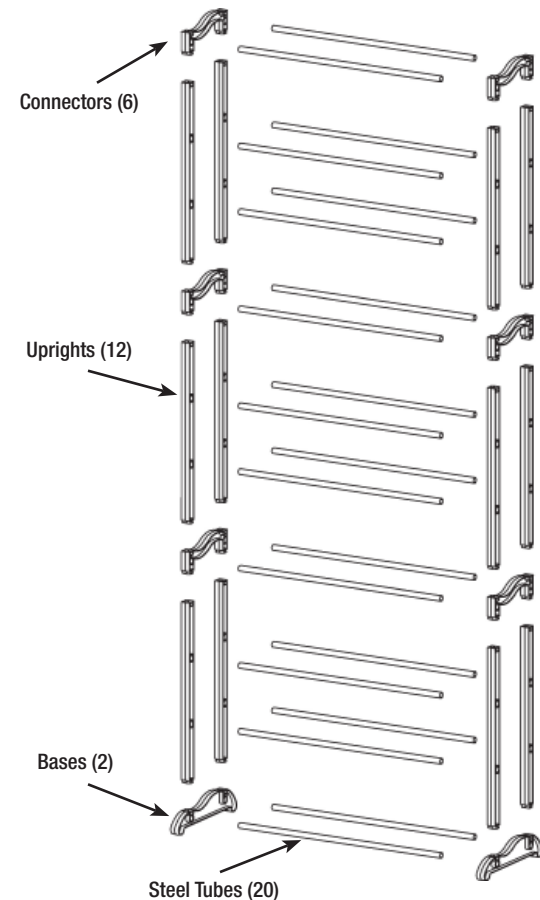

STEP 1: Assemble Bases.
Firmly tap tubes into sockets.

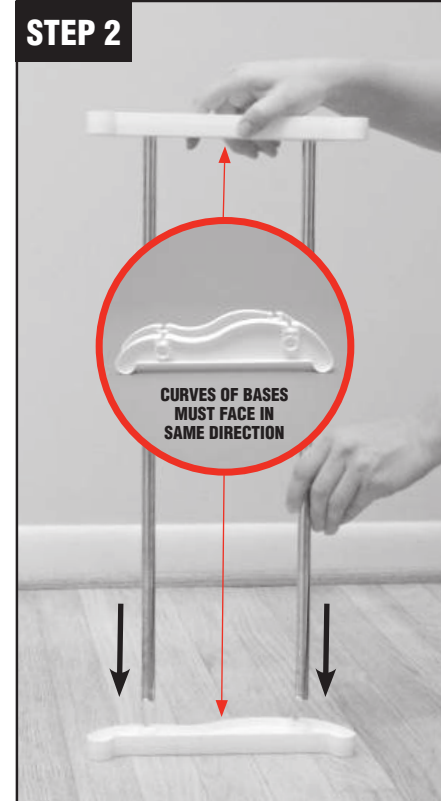

STEP 2: Turn assembly from Step 1 over.
! CURVES OF BASES MUST FACE IN THE SAME DIRECTION



STEP 3: Firmly tap tubes all the way into sockets.

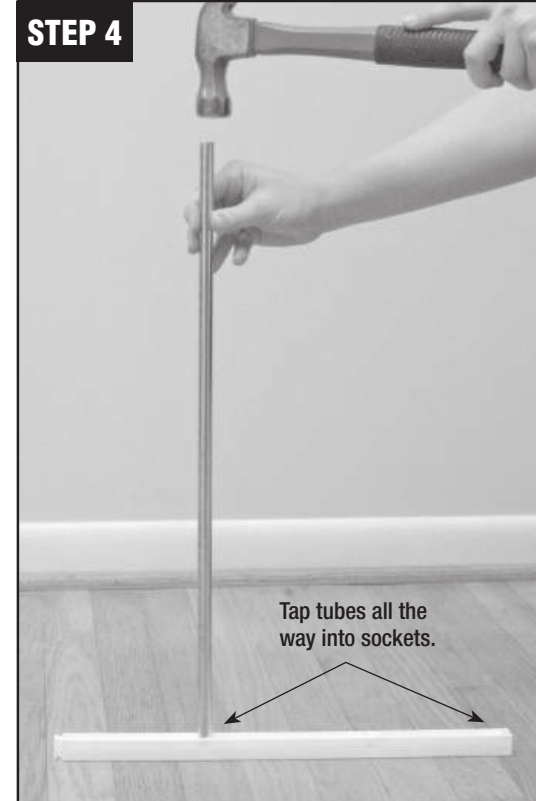

STEP 4: Assemble Uprights.
Firmly tap tubes into sockets.

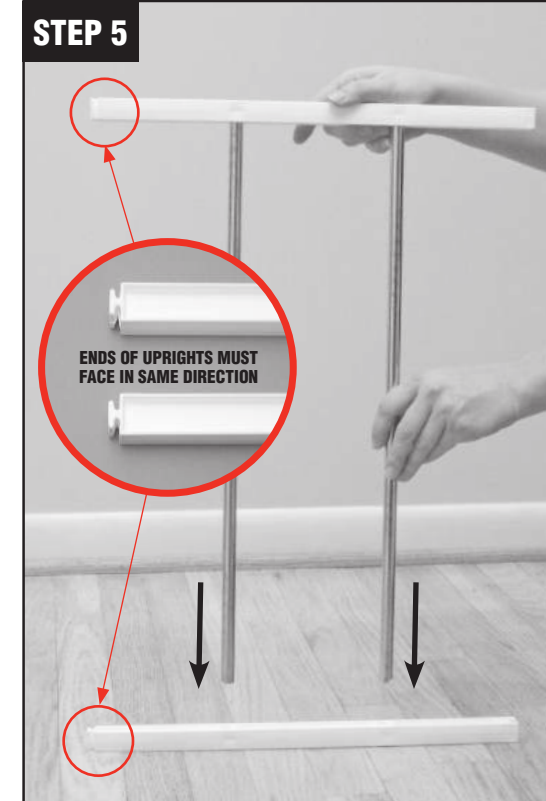

STEP 5: Turn assembly from Step 4 over.
! ENDS OF UPRIGHTS MUST FACE IN THE SAME DIRECTION



STEP 6: Repeat with remaining Uprights.



STEP 7: Assemble Connectors.
Firmly tap tubes into sockets.

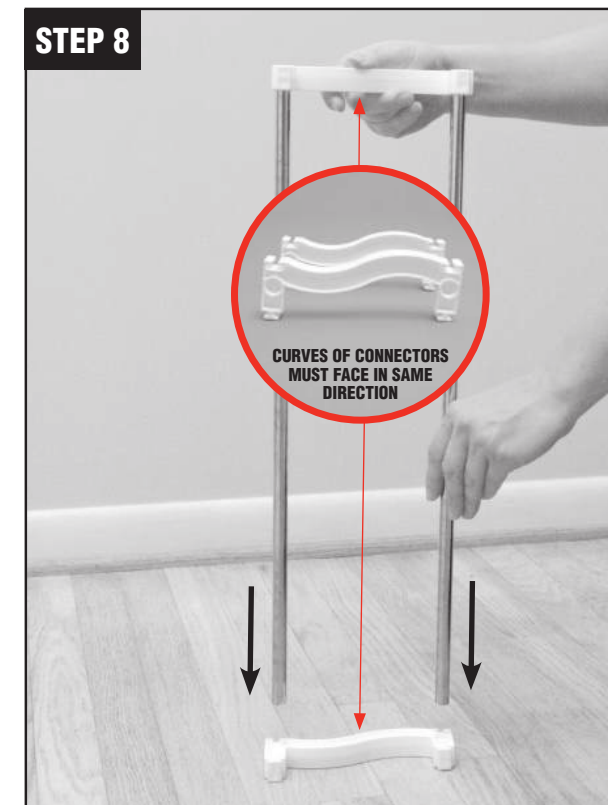

STEP 8: Turn assembly from Step 7 over.
! CURVES OF CONNECTORS MUST FACE IN THE SAME DIRECTION

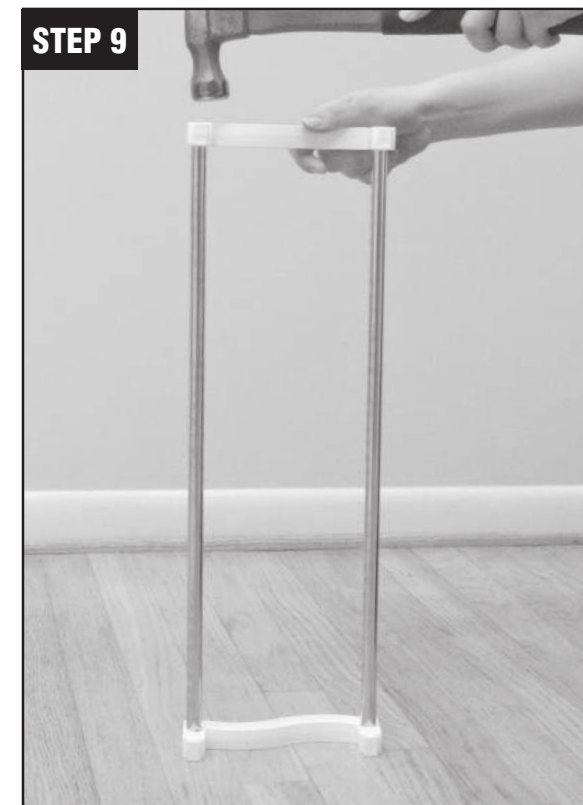

STEP 9: Repeat with remaining Connectors.

TURN PAGE OVER FOR REMAINING STEPS ►

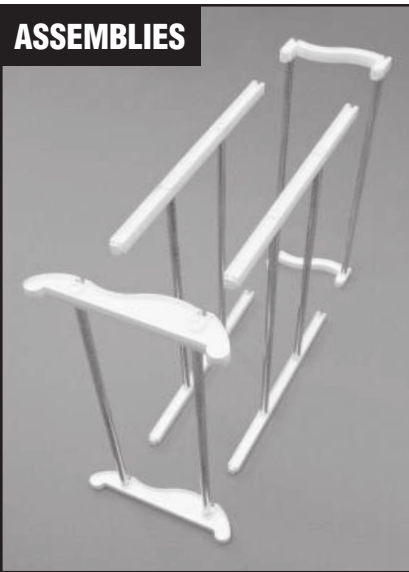

SHOWN: Completed assemblies from front page.



STEP 10: Connect Base and Uprights.

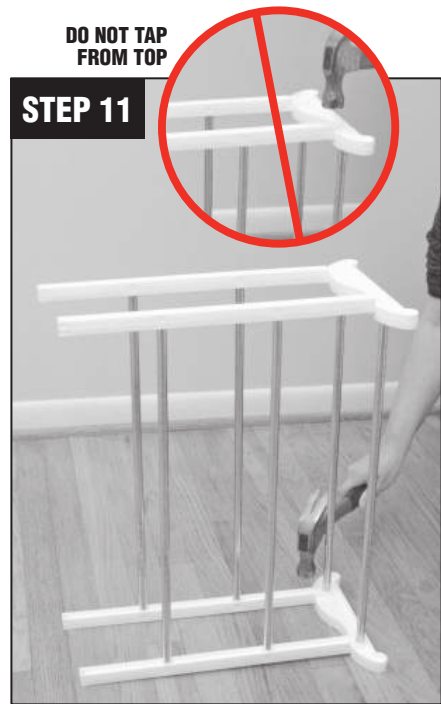

STEP 11: Tap connections together as shown, on a firm surface only.

WARNING! Do not tap connections from the top or damage will occur.

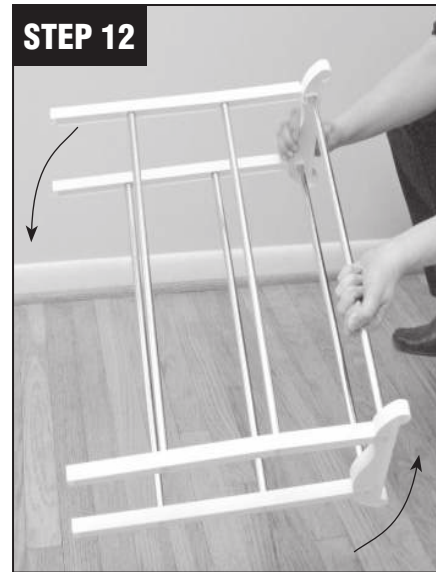

STEP 12: Turn assembly over and tap connections as shown in Step 11.

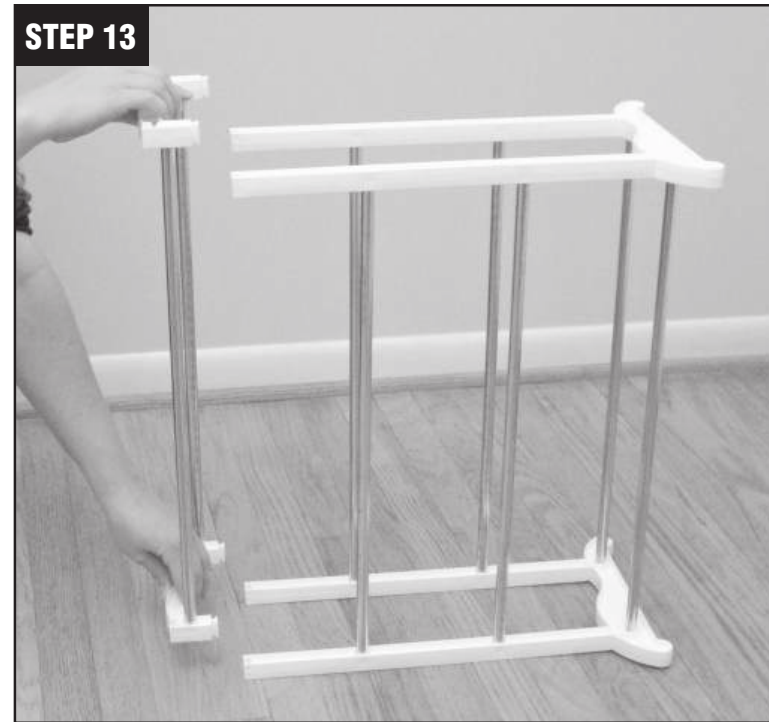

STEP 13: Add Connectors, align in same direction as Base as shown.

WARNING! Be sure the curves of Base and Connector assemblies face in same direction.

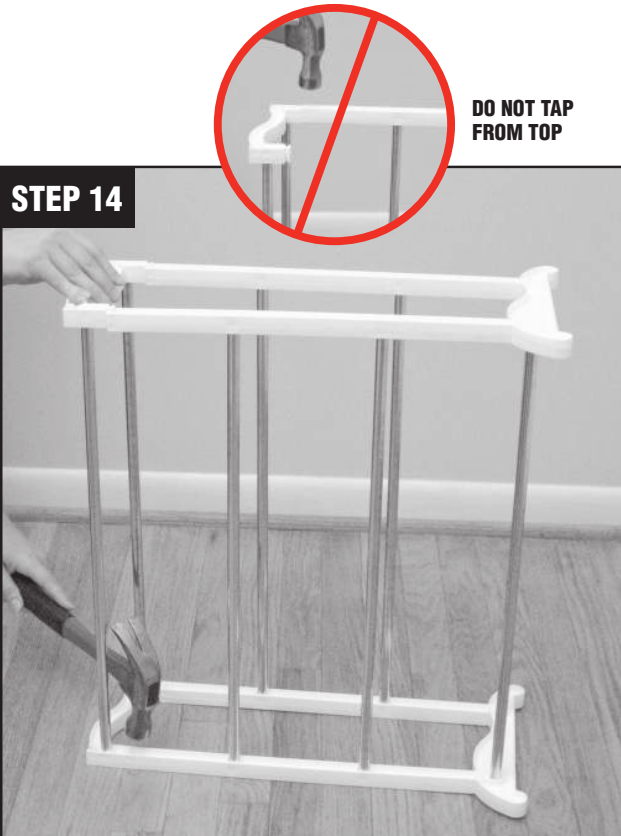
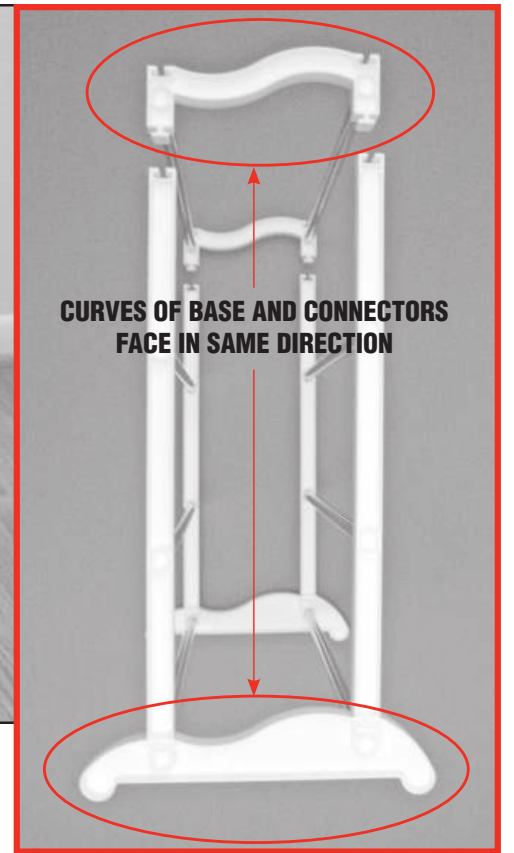

STEP 14: Tap connections together as shown, on a firm surface only.

WARNING! Do not tap connections from the top or damage will occur.



STEP 15: Connect remaining Uprights and Connectors.

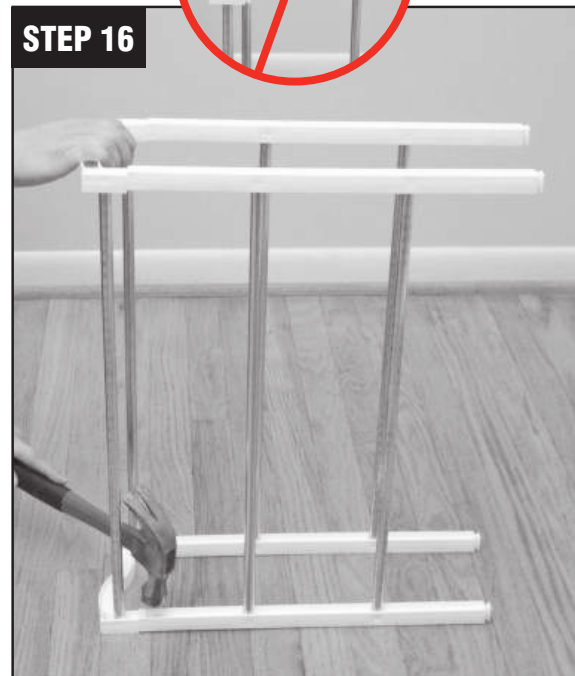

STEP 16: Tap connections together as shown, on a firm surface only.

WARNING! Do not tap connections from the top or damage will occur.

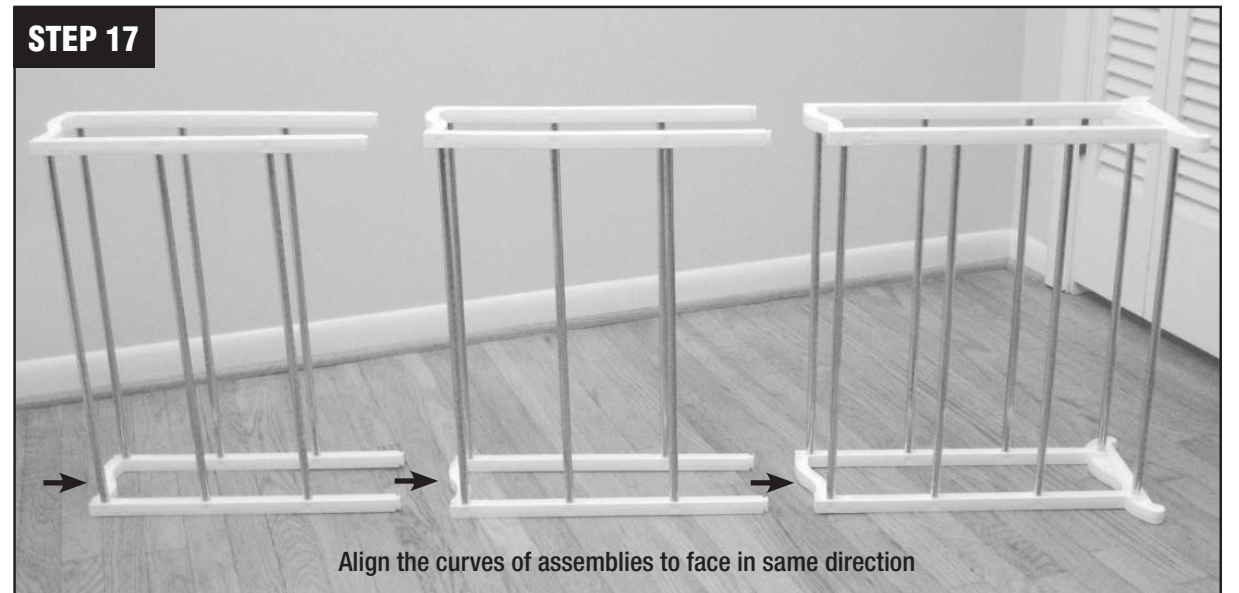

Align the curves of assemblies to face in same direction



STEP 18: Tap connections together as shown, on a firm surface only.

WARNING! Do not tap connections from the top or damage will occur.



LIMITED WARRANTY AND DISCLAIMER OF LIABILITY
The manufacturer warrants this product against defects in manufacturing and workmanship for a period of ninety (90) days from the date of purchase. For questions, call (800) 733-5965 for customer service. MANUFACTURER DISCLAIMS ALL OTHER WARRANTIES, EITHER EXPRESS OR IMPLIED, INCLUDING BUT NOT LIMITED TO IMPLIED WARRANTIES OF MERCHANTABILITY AND FITNESS FOR A PARTICULAR PURPOSE WITH REGARD TO THE PRODUCT. IN NO EVENT SHALL MANUFACTURER BE LIABLE FOR ANY SPECIAL, INCIDENTAL, INDIRECT, OR CONSEQUENTIAL DAMAGES WHATSOEVER (INCLUDING, WITHOUT LIMITATION, DAMAGES FOR LOSS OF BUSINESS PROFITS, INJURY TO PERSON OR PROPERTY, OR ANY OTHER INCIDENTAL, CONSEQUENTIAL OR PECUNIARY LOSS), OR FOR ATTORNEY'S FEES OR COSTS, ARISING OUT OF THE USE OR OPERATION OF THE PRODUCT.

ARRANGEMENTS

Choose among these arrangements for the best way to store your shoes.

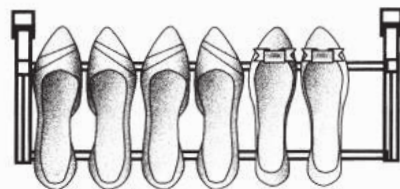

Facing same direction (as shown on package)

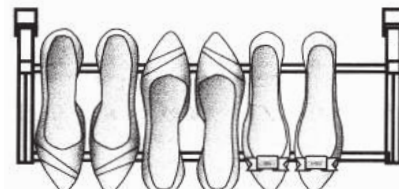

Alternating pairs of shoes

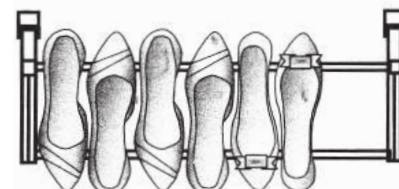

Alternating each shoe

Product #1459014, 30 Pair Shoe Rack OR Product #145950 50 Pair Shoe Rack
For questions, please call 800-733-5965
www.lynkinc.com

LYNK
Form # 6436
© 2009 Lynk, Inc.